

Kennedy Surveying

REGISTERED PROJECT SURVEYORS



Company Profile



Vision and Services

Corporate Overview:











Kennedy Surveying is a progressive, well established family owned business that provides specialist surveying and development services. Our surveying solutions are project tailored to suit client needs, with attention on quality product, professional management and sound advice.

Mission Statement:

To ensure the longevity of our community minded family operated business by providing a premium quality service in a safe and friendly work environment.

We will provide experienced consultation and quality assured products with a focus on all staff members continuing to advance professional qualifications and skill sets.

Services provided by Kennedy Surveying include;

-  Construction Setout Surveys
-  Engineering and Earthworks Surveys
-  Work as Executed Surveys
-  Project and Site Management
-  Contour and Detail Surveys
-  Network GNSS surveys
-  Urban and Rural Torrens Title, Community Title and Strata Title Subdivisions
-  QA monitoring and Audits
-  Hydrographic Surveying
-  GIS data acquisition and management and more.



Our People



NEIL KENNEDY

**Managing Director
Registered Surveyor**

As the Managing Director of Kennedy Surveying Pty Ltd Neil is responsible for business operations, client and government liaisons, Work place Health and Safety and quality assurance.

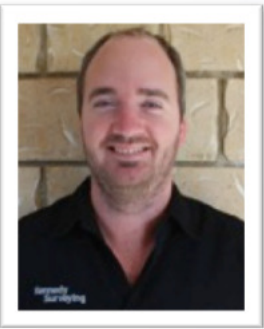

RIENTZ INGLIS

Survey Manager

Rientz's family background in civil and residential construction has given him an intrinsic understanding of construction processes, client liaison and time management. Roles include small and large scale setout projects, Work as Executed surveys, Quality Assurance and survey resource management.



THOMAS SEARLES

**Operations Manager
Registered Surveyor**

Specialising in land tenure, land acquisition and geospatial coordination, Tom is a versatile professional surveyor with personnel management, GIS and field surveying expertise. Roles include control and coordination, cadastral and construction surveys as well as operational and project management.

STAFF CAPACITY

Kennedy Surveying's current staff consists of six surveyors, four survey technicians, CAD operators, chainman and office administration equipped by the latest technology in TPS, GNSS and hydrographic surveying systems.

Our satellite offices allow us to utilize further staff and technical resources should they be required, ensuring our large scale projects are adequately resourced during peak demand.

Kennedy Surveying can Project Manage further technical and advisory requirements through trusted Engineers, Planners and Ecologists working within our professional association.



Major Projects - Infrastructure

Ballina Recycled Water Reticulation

MMA Civil 2013-Present

As part of the Ballina Shire Sustainable Water Management Plan, urban dual reticulation lines were constructed between residential areas, reservoirs and the Waste Water Treatment Plant. Kennedy Surveying provides construction setout, WAX reports as well as GIS information to support development compliance.



Bowraville Off River Storage Scheme (BORS)

Haslin Constructions 2013-Present

The \$35m BORS project involves the construction of a 4500 megalitre dam and associated infrastructure. Kennedy Surveying provides a complete surveying package that includes construction and engineering setout, volume reports, WAX surveys, high level accuracy control/monitoring points and associated project management.

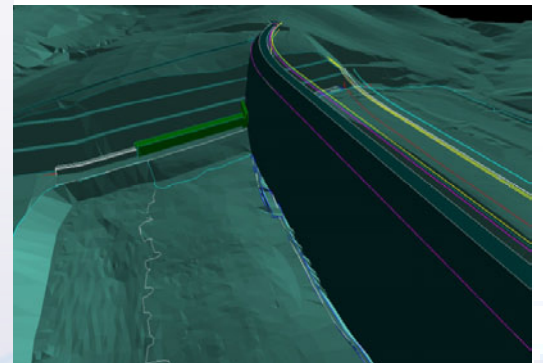

Burringbar to Mooball Pressure Sewer System

Ledonne Constructions 2011-2012

As part of the recent effort to connect outlying communities with reliable waste disposal, Kennedy Surveying was engaged to provide survey setout & WAX data for a combined gravity/pressure sewer system that included control and construction surveys as well as full WAX for individual connections along 300 properties.



Woodburn/Broadwater to Evans Head Sewer Rising Main

Ledonne Constructions 2012/2013

Kennedy Surveying provided accurate surveying setout and WAX information for over 15kms of new sewer rising main to the Evans Head Sewerage Treatment Plant, along with ancillary works for sewerage pump stations.





Major Projects - Buildings

INDUSTRIAL

Ballina & Lennox Head Waste Water Treatment Plant Upgrade

Kennedy Surveying provided detail surveys, construction set out and WAX plans for the \$45m waste water system upgrade. The surveys, which took place while the plant was active, involved careful planning to allow for the loss of survey control as the site redeveloped while maintaining survey accuracy.



GOVERNMENTAL

Building the Education Revolution (BER)

During the BER rollout, Kennedy Surveying was contracted by multiple construction companies for setout and WAE surveys at: St Francis Xavier Primary (*Ballina*), Holy Family Primary (*Skennars Head*), Trinity Catholic College (*Lismore*), Modenville Primary (*Modenville*), Casino Public (*Casino*), Kyogle High (*Kyogle*).



COMMERCIAL

Watermark Apartments Ballina

The survey of this award winning commercial and residential apartment complex involved multi story transfer of vertical and horizontal control through penetration areas by vertical plumb systems. The basement involved below sea level pier marking and services setout.



RESIDENTIAL

Northern New South Wales

Kennedy Surveying has provided dozens of residential builders with building setouts from Grafton to the Queensland border. We can provide contour and detail surveys with following setout and our products can be tailored to suit specific outputs and timeframes.





Major Projects – Land Development

CADASTRAL SURVEYS

Subdivisions for Land Acquisition

RMS/RTA 2009-Present

Bruxner Highway; *Lismore*

Warrell Creek to Urunga; *Valla Beach, Urunga,*
Wells Crossing to Woodburn; *Harwood Island, Woodburn,*
Woodburn to Ballina; *Rileys Hill, Broadwater, Pimlico*
Ballina to Tweed Heads; *Ballina, Lennox Head, Newrybar,*
Tintinbar, Teven,

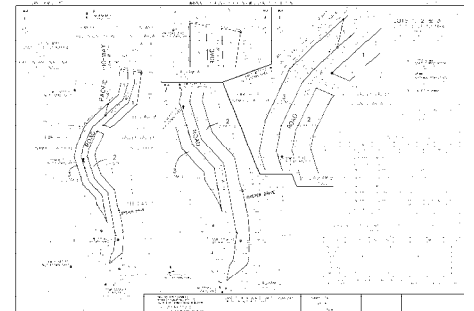

RESIDENTIAL ESTATE DEVELOPMENT

Subdivision Design, Setout & Creation

Lend Lease 2011-Present

Pacific Pines Estate is a residential and commercial land development at Lennox Head designed to house 1700+ people. The development will include shopping centres, commercial space and a community centre, sportsfield, environmental conservation zone and a mixture of low, medium and high density residential allotments.



LOCAL GOVERNMENT LAND SURVEYS

Various Cadastral Plans

North Coast LGA's 2004-Present

Plans for the creation of easements and restrictions, acquisition, subdivision, leases, ambulatory boundary determination, road resumption and title identification for various Public Authorities and Local Governments within New South Wales and Queensland.



INDUSTRIAL LAND DEVELOPMENT

Land Tenure Design & Creation

Broadwater Biomass Co-generation Project 2001-2009

Identification, MHWM determination, subdivision, lease, detail, setout and Work as Executed Surveys for the 30MW base load cogeneration energy plant.



Awards & Accolades

Kennedy Surveying has received many awards for excellence in surveying, including the highest award honoured to New South Wales Spatial Information community by winning the Sir Thomas Mitchell Award for Excellence in Surveying & Spatial Information. Kennedy Surveying has also been acknowledged for a wide variety of charitable work in the local area.

AWARDS

- WINNER Excellence in Surveying & Spatial Information**
Sir Thomas Mitchell Award, Best Overall Project 2008
- WINNER Excellence in Surveying & Spatial Information**
Infrastructure & Construction Category 2008
- WINNER Business Excellence Award**
Professional Services LHCC 2013
Professional Services LHCC 2008

PROFESSIONAL ASSOCIATIONS



Member Institute of Surveyors-NSW-North Coast Group (ISNSW)



Member of the Association of Consulting Surveyors NSW (ACS)



Member of the Surveying & Spatial Sciences Institute (Aust) (MSSSI)



Member of the Spatial Information Business Association (SIBA)

CHARITABLE WORKS

Riding for the Disabled, (2013-2014) for surveying and planning services to the RDA within the Ballina District.

Lennox Head Surf Life Saving Club,(2008-2014) for surveying, planning and professional services for club house redevelopment.

Club Lennox, (2013) for surveying and planning services for the redevelopment of Club Lennox.